

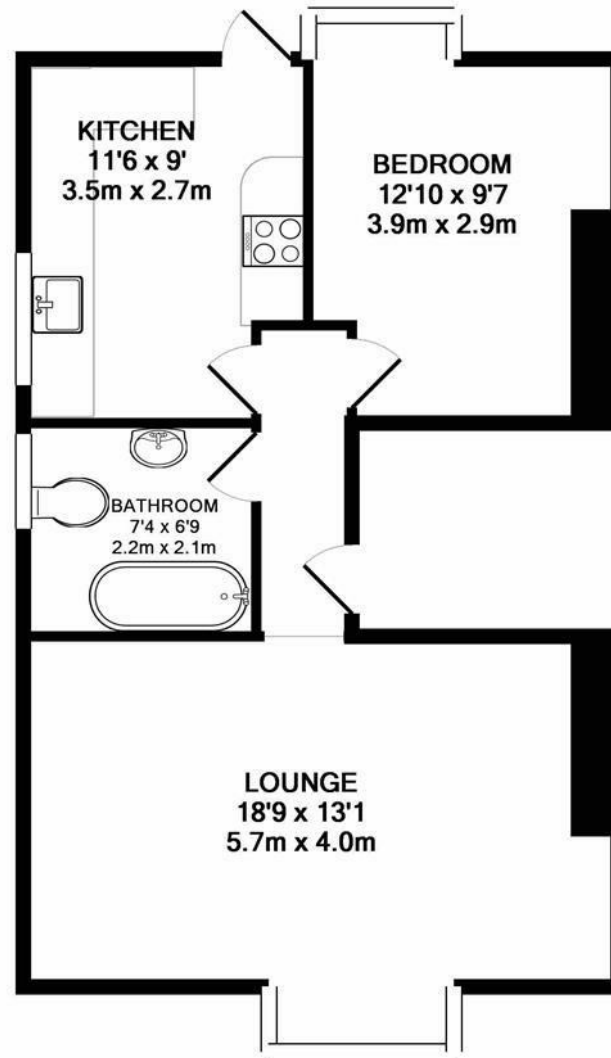

This charming second floor, one bedroom apartment forms part of a sensitive conversion which is ideally located on Granville Gardens, Jesmond Vale. Granville Gardens, close to Jesmond Dene, is just a short walk to the cafés, shops and restaurants of Jesmond, excellent local schools and indeed Newcastle City Centre itself.

The accommodation briefly comprises: communal entrance hall with stairs to second floor; private entrance hall; 18ft lounge with stripped wood flooring and dormer window with seating area; kitchen with fitted units and hardwood work surfaces including Belfast sink unit and rear door access to the stairs and fire escape; double bedroom with part bay and stripped wood flooring; bathroom, complete with three piece suite. Externally, a communal west facing garden to the rear with a paved patio seating area, fenced boundaries and a pleasant green outlook. With electric heating and double glazing throughout, early viewings are advised!

2nd Floor Conversion Apartment | 492 Sq ft (45.7m²) | One Bedroom | 28ft Lounge | Kitchen | Bathroom | Communal West Facing Rear Garden | DG | No Onward Chain | Close to Jesmond Dene | Leasehold with Share of Freehold 976 Years Remaining | Service Charge £600 PA | Council Tax Band A | EPC: D



TOTAL APPROX. FLOOR AREA 492 SQ.FT. (45.7 SQ.M.)

Whilst every attempt has been made to ensure the accuracy of the floor plan contained here, measurements of doors, windows, rooms and any other items are approximate and no responsibility is taken for any error, omission, or mis-statement. This plan is for illustrative purposes only and should be used as such by any prospective purchaser. The services, systems and appliances shown have not been tested and no guarantee as to their operability or efficiency can be given

Made with Metropix ©2018

Offers Over £140,000

IMPORTANT NOTE: These particulars and the descriptions and measurements herein do not constitute representation and whilst every effort has been made to ensure accuracy, this cannot be guaranteed.

